

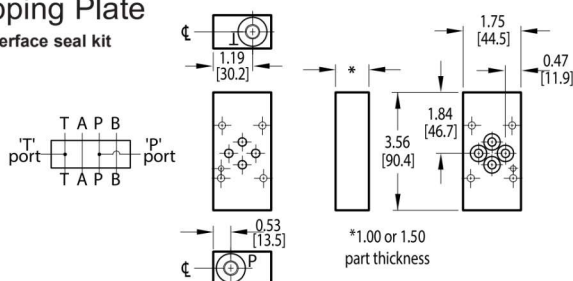

Tapping Plate hardware / interface seal kit is supplied.

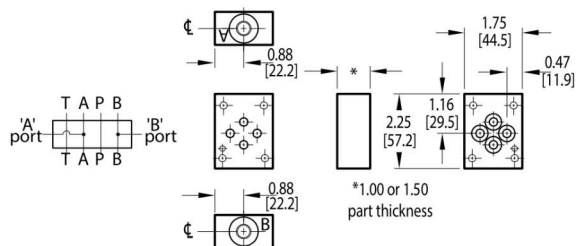

Tapping Plate hardware / interface seal kit is supplied.



Tapping Plate hardware / interface seal kit is supplied.

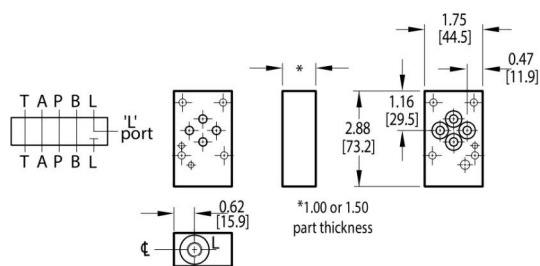

Ordering Information

Material		Valve Pattern	Product Type	Circuit	Port Threads	Thickness																														
<table><tr><th colspan="2">Material</th></tr><tr><td>A</td><td>Aluminum - 6061-T6 3000† psi • 20.7 MPa</td></tr><tr><td>D</td><td>Ductile Iron - D4512 5000† psi • 34.5 MPa</td></tr><tr><td colspan="2">† Working pressure should be considered in accordance with ISO 4413 to determine appropriate material type.</td></tr></table>		Material		A	Aluminum - 6061-T6 3000† psi • 20.7 MPa	D	Ductile Iron - D4512 5000† psi • 34.5 MPa	† Working pressure should be considered in accordance with ISO 4413 to determine appropriate material type.			<table><tr><th colspan="2">Product Type</th></tr><tr><td>TP</td><td>Tapping Plate</td></tr></table>	Product Type		TP	Tapping Plate		<table><tr><th colspan="2">Port Threads</th></tr><tr><td>4P</td><td>0.25-18 NPTF ANSI B1.20.3</td></tr><tr><td>4S</td><td>-4 SAE ISO 11926; SAE 1926</td></tr><tr><td>4B</td><td>0.25-19 BSPP ISO 1179; BS 2779</td></tr><tr><td>4M</td><td>M10 x 1.0 ISO 6149</td></tr><tr><td>4T</td><td>0.25-19 BSPT ISO 7; BS 21</td></tr></table> <p>For larger ports, see next page (p. 158.1).</p>	Port Threads		4P	0.25-18 NPTF ANSI B1.20.3	4S	-4 SAE ISO 11926; SAE 1926	4B	0.25-19 BSPP ISO 1179; BS 2779	4M	M10 x 1.0 ISO 6149	4T	0.25-19 BSPT ISO 7; BS 21	<table><tr><th colspan="2">Thickness</th></tr><tr><td>150</td><td>For 1.5" thickness</td></tr><tr><td colspan="2">OMIT for standard 1" thickness</td></tr></table>	Thickness		150	For 1.5" thickness	OMIT for standard 1" thickness	
Material																																				
A	Aluminum - 6061-T6 3000† psi • 20.7 MPa																																			
D	Ductile Iron - D4512 5000† psi • 34.5 MPa																																			
† Working pressure should be considered in accordance with ISO 4413 to determine appropriate material type.																																				
Product Type																																				
TP	Tapping Plate																																			
Port Threads																																				
4P	0.25-18 NPTF ANSI B1.20.3																																			
4S	-4 SAE ISO 11926; SAE 1926																																			
4B	0.25-19 BSPP ISO 1179; BS 2779																																			
4M	M10 x 1.0 ISO 6149																																			
4T	0.25-19 BSPT ISO 7; BS 21																																			
Thickness																																				
150	For 1.5" thickness																																			
OMIT for standard 1" thickness																																				
		<table><tr><th colspan="2">Valve Pattern</th></tr><tr><td>D03</td><td>ISO 4401-03-02 NFA T3.5.1-D03 See Tech Information</td></tr></table>	Valve Pattern		D03	ISO 4401-03-02 NFA T3.5.1-D03 See Tech Information	<table><tr><th colspan="2">Circuit</th></tr><tr><td>PT</td><td>P and T ports provided</td></tr><tr><td>AB</td><td>A and B ports provided</td></tr><tr><td>L</td><td>L port provided</td></tr></table>	Circuit		PT	P and T ports provided	AB	A and B ports provided	L	L port provided																					
Valve Pattern																																				
D03	ISO 4401-03-02 NFA T3.5.1-D03 See Tech Information																																			
Circuit																																				
PT	P and T ports provided																																			
AB	A and B ports provided																																			
L	L port provided																																			

Customers have the responsibility continuously check all the information on all data sheets.