

D03 Tapping Plates

P and T Port Tapping Plate

Tapping Plate hardware / interface seal kit is supplied. See page 180 for itemized list.

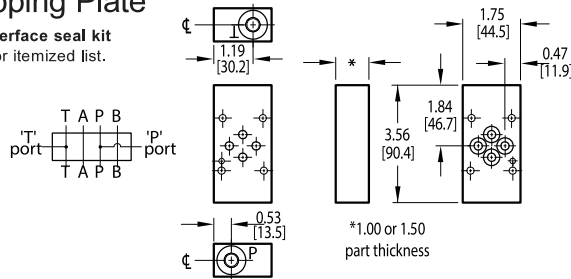

A and B Port Tapping Plate

Tapping Plate hardware / interface seal kit is supplied. See page 180 for itemized list.

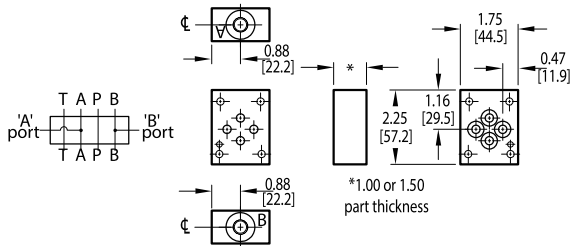

L Port Tapping Plate

Tapping Plate hardware / interface seal kit is supplied. See page 180 for itemized list.

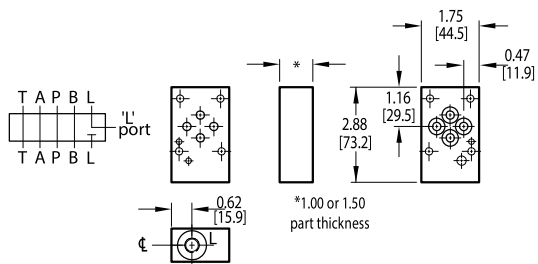

Ordering Information

For coating options see pages 245-246.

Material	Valve Pattern	Product Type	Circuit	Port Threads	Thickness
Material A Aluminum - 6061-T6 3000† psi • 20.7 MPa D Ductile Iron - D4512 5000† psi • 34.5 MPa † Working pressure should be considered in accordance with ISO 4413 to determine appropriate material type.	Valve Pattern D03 ISO 4401-03-02 NFPA T3.5.1-D03 See Tech Information	Product Type TP Tapping Plate	Circuit PT P and T ports provided AB A and B ports provided L L port provided	Port Threads 4P 0.25-18 NPTF ANSI B1.20.3 4S -4 SAE ISO 11926; SAE 1926 4B 0.25-19 BSPP ISO 1179; BS 2779 4M M10 x 1.0 ISO 6149 4T 0.25-19 BSPT ISO 7; BS 21 For larger ports, see next page (p. 158.1).	Thickness 150 For 1.5" thickness OMIT for standard 1" thickness