

D05 Tapping Plates

P and T Port Tapping Plate

Tapping Plate hardware / interface seal kit is supplied. See page 180 for itemized list.

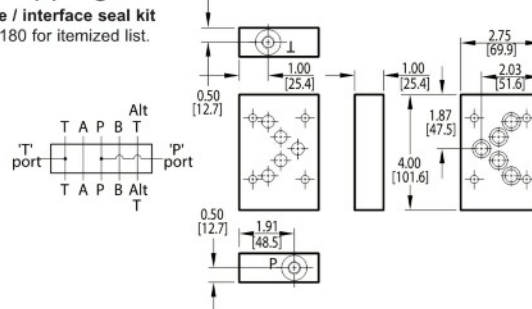

A and B Port Tapping Plate

Tapping Plate hardware / interface seal kit is supplied. See page 180 for itemized list.

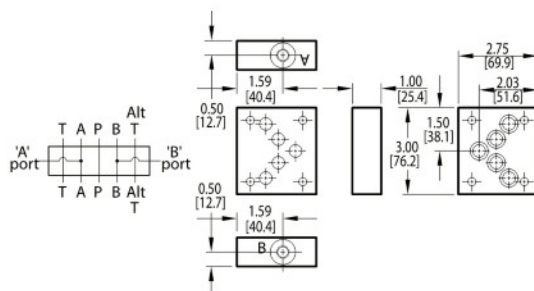

L Port Tapping Plate

Tapping Plate interface seal kit is supplied. See page 180 for itemized list.

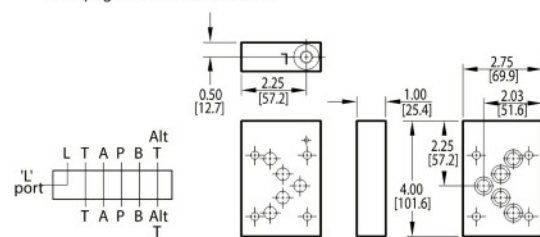

Specifications, descriptions, and dimensional data are subject to correction or change without notice or incurring obligation. Download latest catalog page revisions at www.daman.com.

Ordering Information

Material	Valve Pattern	Product Type	Circuit	Port Threads
Material A Aluminum - 6061-T6 3000† psi • 20.7 MPa D Ductile Iron - D4512 5000† psi • 34.5 MPa † Working pressure should be considered in accordance with ISO 4413 to determine appropriate material type.	Valve Pattern D05 ISO 4401-05-04 NFPA T3.5.1-D05 See Tech Information	Product Type TP Tapping Plate	Circuit PT P and T ports provided AB A and B ports provided L L port provided	Port Threads 4P 0.25-18 NPTF ANSI B1.20.3 4S -4 SAE ISO 11926; SAE 1926 4B 0.25-19 BSPP ISO 1179; BS 2779 4M M10 x 1.0 ISO 6149 4T 0.25-19 BSPT ISO 7; BS 21

For coating options see pages 245-246.

MA Hydraulics Ltd Units 11-12 Ashley Estate Exmoor Avenue Scunthorpe North Lincolnshire DN15 8NJ

In order to constantly improve the quality of our products, we retain the right to make changes to the products and specifications at any time without prior notice.

Customers have the responsibility to continuously check all the information on all data sheets.