

B

PV Series Variable Volume Piston Pumps

Pmax : 280 bar (4000 psi)
 Qmax : 8 cc/rev ~ 100 cc/rev
 Mounting Type : SAE 2-bolt DIN 4-bolt
 Fluid : ISO VG32 or VG68
 Viscosity & Temp : 20~200 cSt & -5 °C to 60 °C
 Filtration : 100 Microns (150 mesh) Absolute or Finer
 Alignment and installation of pumps : within 0.05 TIR (0.002 in)
 Many options in control type selection
 Applications: Construction, Agricultural, Excavator and Industrial Vehicle

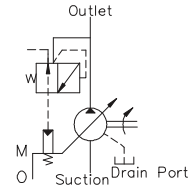
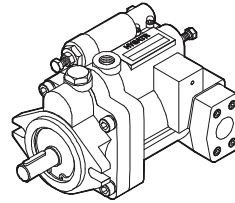

Ordering Code -PV Piston Pumps

PV	36	A	4	R	S	F	-20
Series No	Displacement cc/rev (in ³ /rev)	Control Types	Pressure Compensating range	Rotation	Port Position	Mounting	Design No. Shaft Option Flange Option
PV: Variable Volume Piston Pump	8, (0.5) 16, (1.0) 22, (1.3) 36, (2.1) 46, (2.7) 70, (4.3) 100, (6.1)	■ Standard A : Pressure Compensating (Manual) Option B : Pressure Compensating Type Pilot (Remote Control) C : Two Pressure - Two Flow Control Type D : Solenoid Cut- Off Control Type Control Type E : Two Pressure Cut- Off Control Type F : Two-Pressure, Two-Flow Control Type by Solenoid Valve G : Two-Pressure, Two-Flow Control Type by Solenoid Valve HL : Load Sensing Compensator	0: 10~ 35 bar (143~ 500 psi) 1: 20~ 70 bar (286~1000 psi) 2: 30~140 bar (429~2000 psi) 3: 30~210 bar (429~3000 psi) 4: 50~280 bar (720~4000 psi)	R: Clockwise (CW) L: Counter- Clockwise (CCW) <small>Viewed from Shaft End</small>	S: Side Port R: Axial Port (Rear Port)	F: Flange Mounting L: Foot Mounting	Design No.
				20: PT(Rc) Flange Kits, Straight Key 2080: PF(G) Flange Kits, Straight Key 2090: NPT Flange Kits, Straight Key			

Ratings

Model	Volume cc/rev in ³ /rev	Delivery at No Load lpm (USgpm)				Pressure Compensating Range		MAX Setting Pressure		Drive Speed rpm		Weight kgf (lbs)
		1000rpm	1200rpm	1500rpm	1800rpm	bar	(psi)	bar	(psi)	Min.	Max.	
PV-8*-0**-20 PV-8*-1**-20 PV-8*-2**-20 PV-8*-3**-20	8.0 (0.50)	8.0 (2.1)	9.6 (2.5)	12.0 (3.2)	14.4 (3.8)	10 ~ 35 20 ~ 70 30 ~ 140 30 ~ 210	(143 ~ 500) (286 ~ 1000) (429 ~ 2000) (429 ~ 3000)	35 70 140 210	(500) (1000) (2000) (3000)	500	2000	7.5 (16.4)
PV-16*-0**-20 PV-16*-1**-20 PV-16*-2**-20 PV-16*-3**-20	16.5 (1.01)	16.5 (4.4)	19.8 (5.2)	24.7 (6.5)	29.7 (7.8)	10 ~ 35 20 ~ 70 30 ~ 140 30 ~ 210	(143 ~ 500) (286 ~ 1000) (429 ~ 2000) (429 ~ 3000)	35 70 140 210	(500) (1000) (2000) (3000)	500	2000	10.5 (23.0)
PV-22*-0**-20 PV-22*-1**-20 PV-22*-2**-20 PV-22*-3**-20	22.2 (1.34)	22.0 (5.8)	26.4 (7.0)	33.0 (8.7)	39.6 (10.5)	10 ~ 35 20 ~ 70 30 ~ 140 30 ~ 210	(143 ~ 500) (286 ~ 1000) (429 ~ 2000) (429 ~ 3000)	35 70 140 210	(500) (1000) (2000) (3000)	500	2000	10.5 (23.0)
PV-36*-0**-20 PV-36*-1**-20 PV-36*-2**-20 PV-36*-3**-20	36.0 (2.14)	36.0 (9.2)	42.0 (11.1)	52.5 (13.9)	63.0 (16.6)	10 ~ 35 20 ~ 70 30 ~ 140 30 ~ 210	(143 ~ 500) (286 ~ 1000) (429 ~ 2000) (429 ~ 3000)	35 70 140 210	(500) (1000) (2000) (3000)	500	2000	23.0 (51.0)
PV-46*-0**-20 PV-46*-1**-20 PV-46*-2**-20 PV-46*-3**-20	46.0 (2.76)	46.0 (11.9)	54.0 (14.3)	67.5 (17.9)	81.0 (21.5)	10 ~ 35 20 ~ 70 30 ~ 140 30 ~ 210	(143 ~ 500) (286 ~ 1000) (429 ~ 2000) (429 ~ 3000)	35 70 140 210	(500) (1000) (2000) (3000)	500	2000	23.0 (51.0)
PV-70*-1**-20 PV-70*-3**-20 PV-70*-4**-20	70.0 (4.27)	70.0 (18.5)	84.0 (22.2)	105.0 (27.7)	126.0 (33.3)	20 ~ 70 20 ~ 210 20 ~ 280	(286 ~ 1000) (286 ~ 3000) (286 ~ 4000)	70 210 280	(1000) (3000) (4000)	500	2000	37.0 (82.0)
PV-100*-1**-20 PV-100*-3**-20 PV-100*-4**-20	100.0 (6.10)	100.0 (26.5)	120.0 (31.8)	150.0 (39.7)	180.0 (47.6)	20 ~ 70 20 ~ 210 20 ~ 280	(286 ~ 1000) (286 ~ 3000) (286 ~ 4000)	70 210 280	(1000) (3000) (4000)	500	2000	58.0 (129.0)

DIMENSIONS

MILLIMETERS(INCHES)

CROSS-SECTION

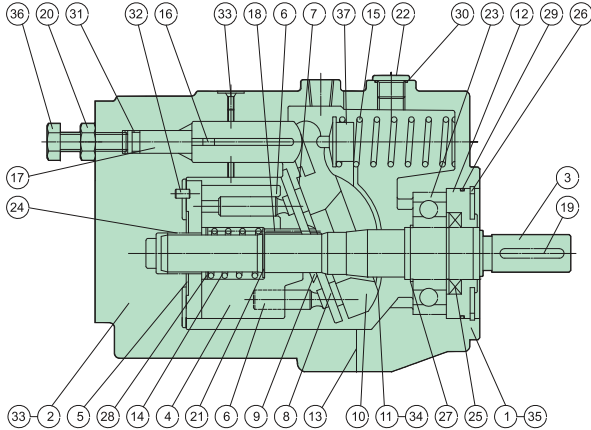

No.	PART NAME	No.	PART NAME	No.	PART NAME
1	Pump Housing	15	Spring S	29	Oil-Ring
2	Rear Cover	16	Control Piston	30	Oil-Ring
3	Shaft	17	Guide	31	Oil-Ring
4	Cylinder Barrel	18	Needle	32	Pin
5	Valve Plate	19	Key	33	Expander plug
6	Piston	20	Nut	34	Machine screw
7	Shoe	21	Retainer	35	Hexagon Socket Head Screw
8	Shoe holder	22	Plug	36	Flow Adjusting Bolt
9	Barrel Holder	23	Ball Bearing	37	Spring Holder
10	Swash Plate	24	Needle Bearing	38	Hexagon Socket Head Screw
11	Thrust Bush	25	Oil Seal	39	
12	Seal Holder	26	Snap Ring	40	
13	Gasket	27	Snap Ring	41	
14	Spring C	28	Snap Ring	42	

PV-08 A-Type

■ Side Port-Standard

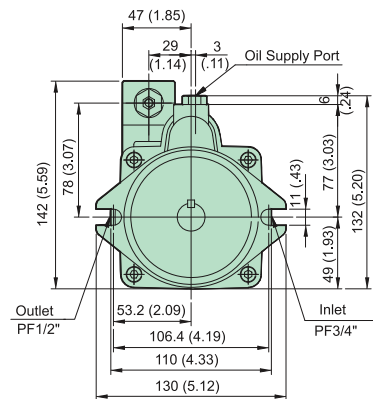
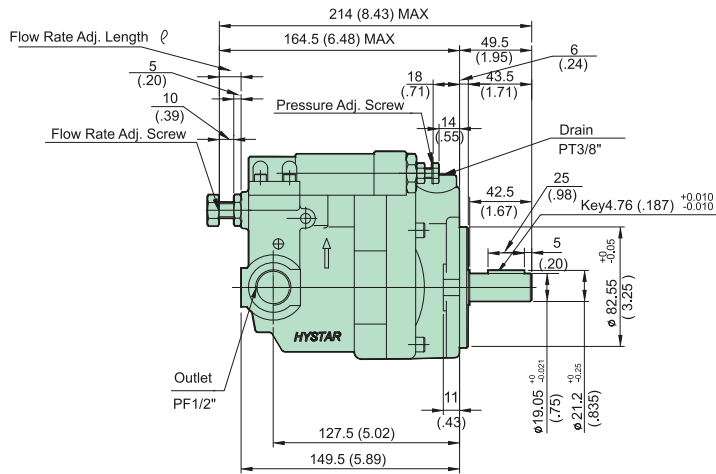

PV-08 B-Type

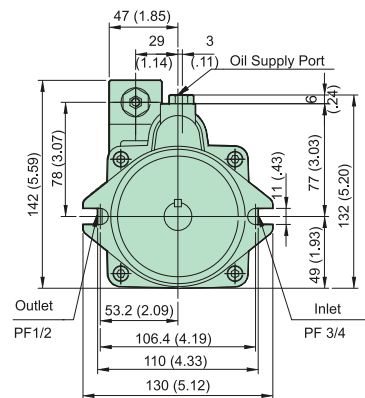
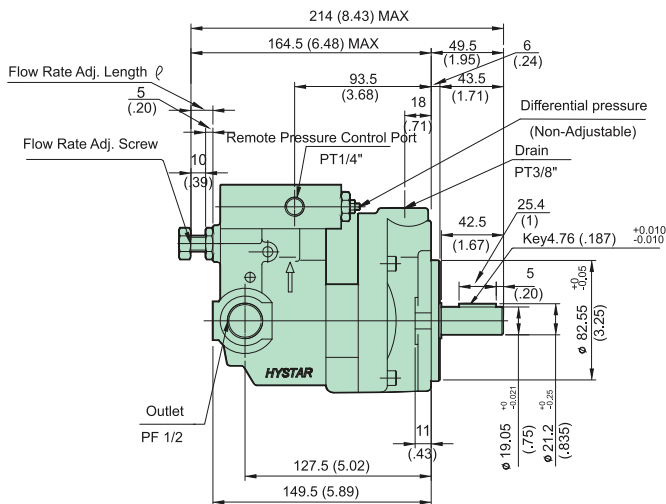



DIMENSIONS

MILLIMETERS(INCHES)

PV-16/22 A-Type

■ Side Port-Standard

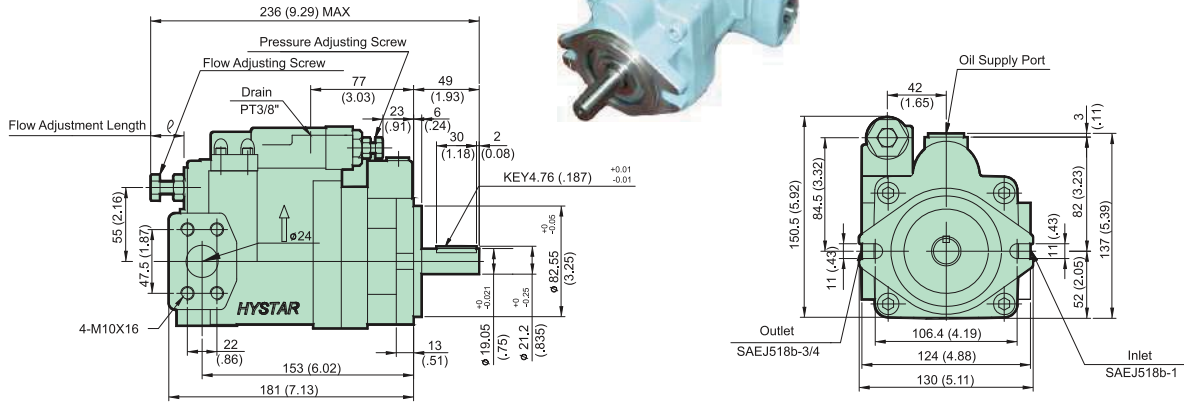

PV-16/22 A-Type

**Rear Port(Axial Port)

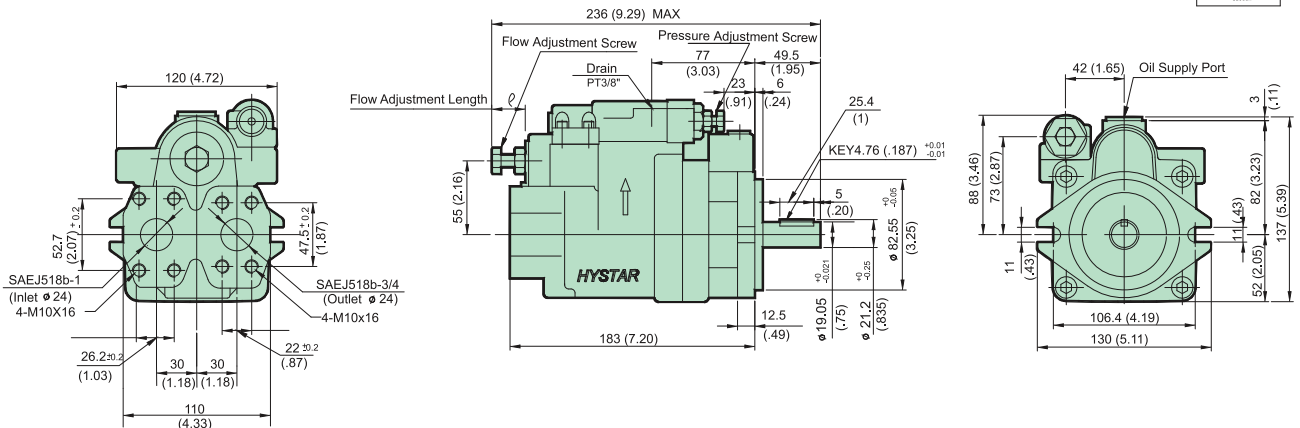

PV-16/22 B-Type

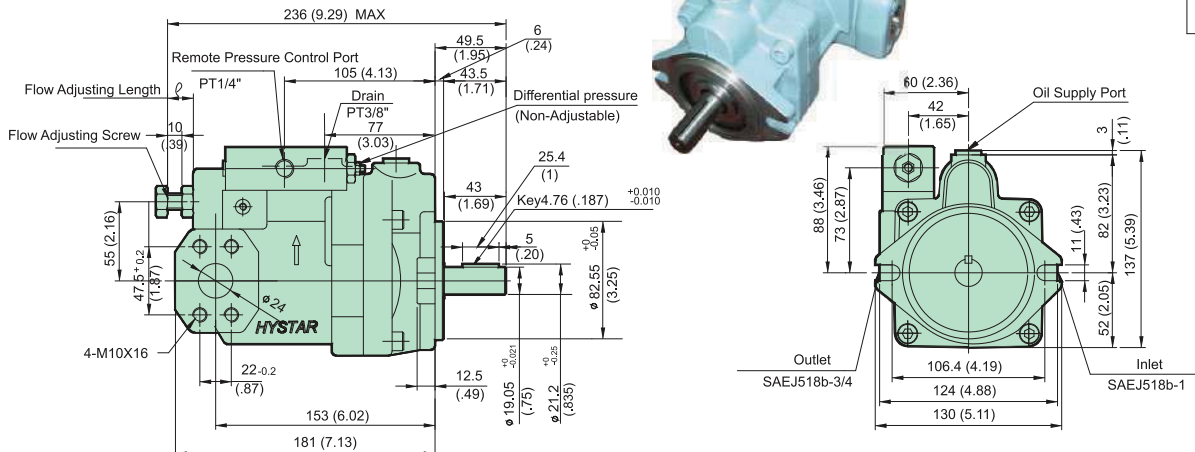

B

PV-36/46 G-Type

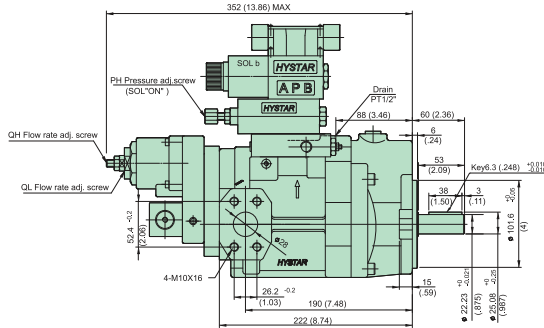

PV-36/46 HL-Type

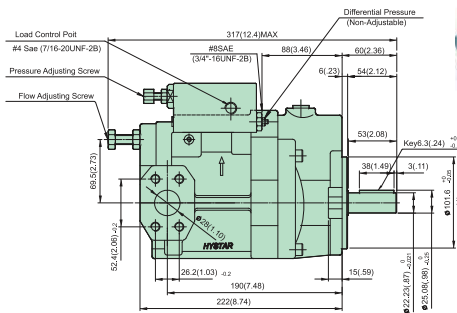

PV-70 A-Type

■ Side Port-Standard

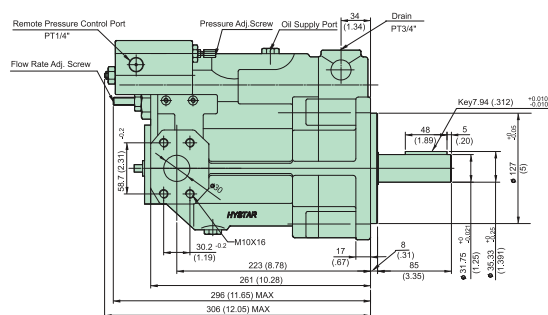

PV-100 A-Type

■ Side Port-Standard

